

STAGE 2 WESTERN KERB

6am Thursday – 11pm Sunday: 13 - 16 June, 20 - 23 June, 27 - 30 June



Footpaths will not be impacted. Pedestrian movement along King William Road and access to businesses will be maintained

Local streets around King William Road will be accessible

Traffic will be able to turn in to side streets from King William Road

Traffic will not be able to turn on to King William Road from side streets between Arthur Street and Park/Mitchell Street intersection

Two way traffic on King William Road will be permitted using a single lane managed by stop/go controls during hours of work and temporary traffic lights at other times

On-street parking on the eastern side of King William Road will be maintained

On-street parking on the western side of King William Road will not be available during Stage 2 to enable works to occur

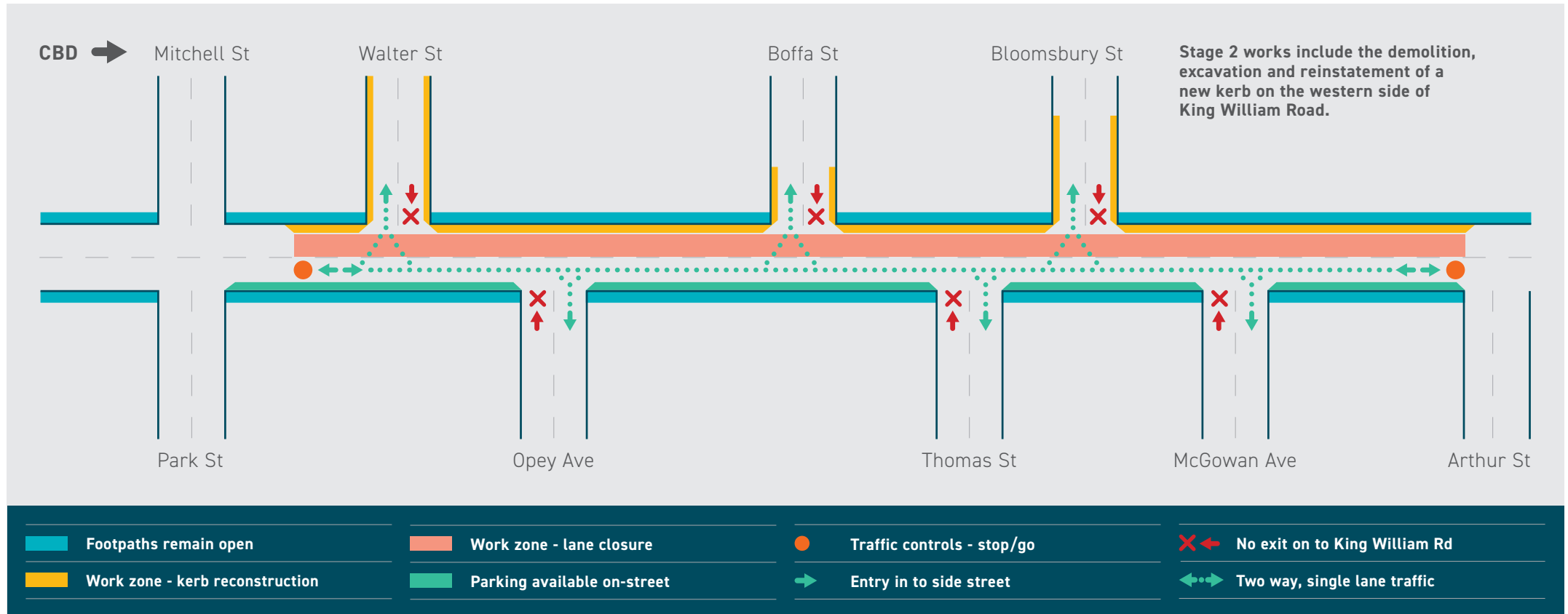

SHAPE
REIMAGINE
TRANSFORM

1300 617 363
designkingwilliam.com
KWREnquiries@bmd.com.au
facebook.com/designkingwilliam



**Businesses are open during construction.
Show your support while we transform your King William Road.**

Dates are subject to change due to weather conditions and technical requirements. For the latest updates, visit designkingwilliam.com